

NOTES:

1. MATERIAL AND PLATING  
SHELL,BODY=BRASS,NICKEL PLATED;  
CONTACT=MALE BRASS,GOLD PLATED;  
INSULATOR=PTFE;
2. DO NOT SCALE THIS DRAWING.
3. UNLESS OTHERWISE SPECIFIED, ALL DIMENSIONS ARE AFTER PLATING.
4. RoHS COMPLIANT
5. CHARACTERISTIC IMPEDANCE:50Ω
6. FREQUENCY RANGE:0~3GHz
7. WORKING VOLTAGE:400VRMS
8. DIELECTRIC WITHSTANDING VOLTAGE:2500VRMS
9. VSWR:1.15MAX
10. INSULATOR RESISTANCE:5000 MEGOHMS MIN

37.9

17.5

17.5

28.5

7.5

∅4.1

∅6.5

∅7.5

5/8-24UNEF-2B

21.6

7

4

cable stripping size

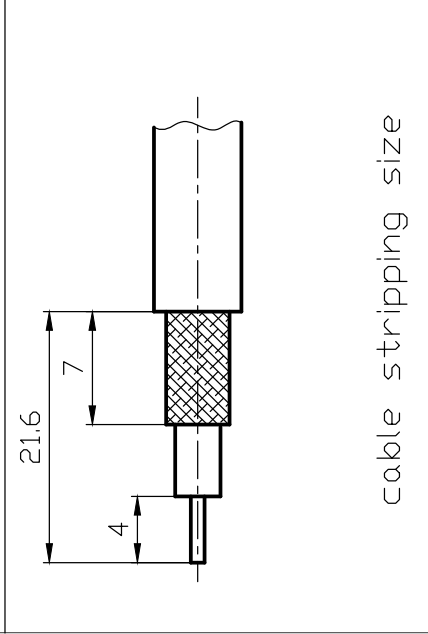
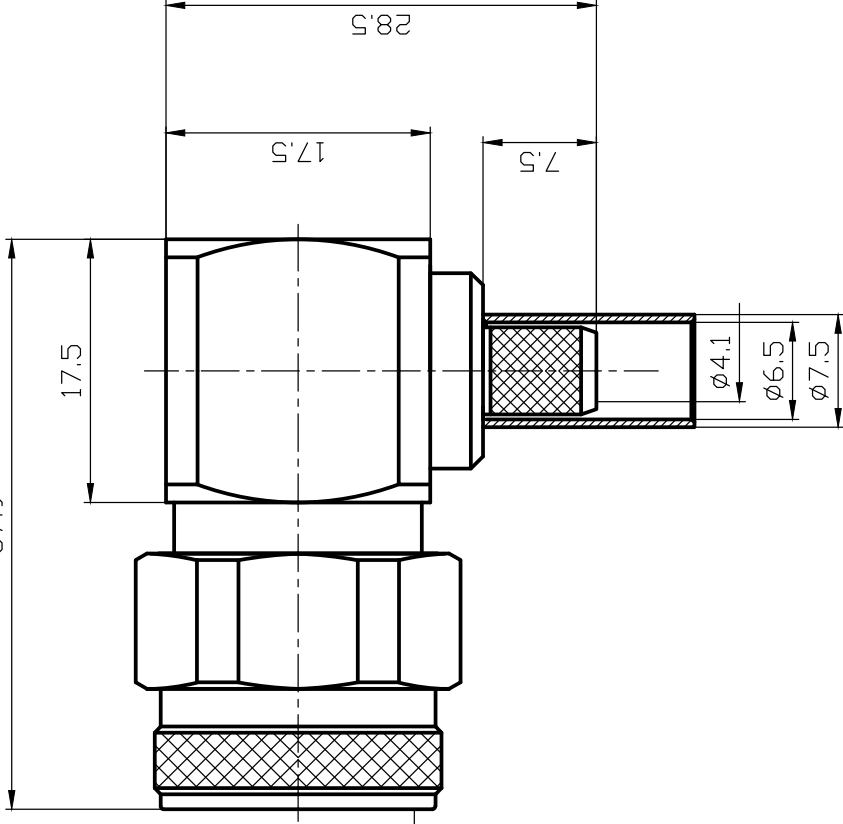

REVISIOND				
DRAWING NO	REV	DESCRIPTION	DATE	APPR
THIRD ANGLE PROJ.				

MATERIAL		DRAWN	DATE	TITLE	SHIREEN INC. 12910 Cloverleaf Center Dr Ste 110 Germantown, MD 20874 USA	
REFERENCE		DRAWN	DATE	Type N Male Right Angle RFC240	SCALE : 2.5:1	SHEET 1 OF 1
UNLESS OTHERWISE SPECIFIED, DIMENSIONS ARE IN MM AND TOLERANCES ARE:		DRAWN	DATE	CON-4015	DRAWING NO	
2 PLACE DESIMAL	3 PLACE DESIMAL					REV
±0.015 (0.381mm)	±0.005(0.127mm)					A
	ANGLES					
	±1°					