

1	2	3	4	5	6	7	8
REV	DESCRIPTION	ECN NO.	NAME	DATE			
V1							

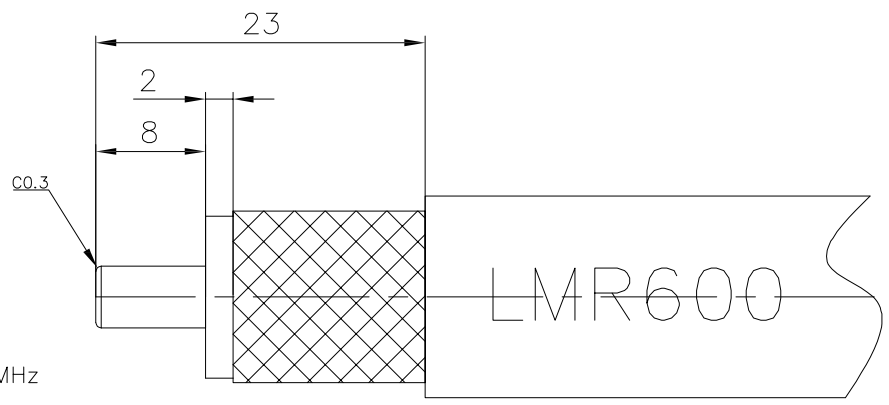
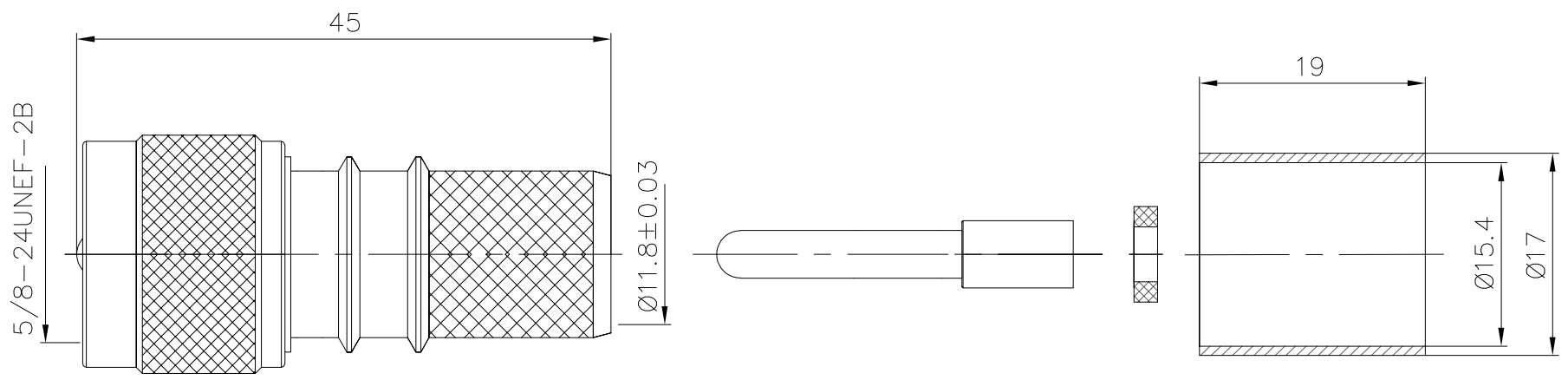

ELECTRICAL SPECIFICATION
 -Frequency range from DC to 500 MHz
 -Impedance 50 Ohm
 -VSWR TBD

MECHANICAL SPECIFICATION
 -Body material Brass
 -Center contact material Brass
 -Insulator material PTFE
 -Body finish Ni Plating
 -Center contact finish Gold Plating

MECHANICAL CHARACTERISTICS
 Center contact retention
 -Axial force 6 Lbs min.

ENVIRONMENTAL SPECIFICATIONS
 -Operating temperature range from -65° to +165°C

REV	V1	SCALE	2:1	ITEM NO.	
WEIGHT(g)	-			CON-6001	
SURFACE(mm ²)	-			APPROVED	
UNLESS OTHERWISE SPECIFIED TOLERANCES				CHECKED	TITLE
TOLERANCES				DRAWN	UHF MALE FOR RFC600 CABLE
1. * ±0.1				DATE 2022-04-18	DRAWING NO.
2. ** ±0.1					
3. ANGLE ±3°					
4 T.I.R 0.1					
5. SURFACE ROUGHNESS Ra1.6					
6. EDGES 0.15 MAX.					
* MAJOR DIMENSION					